

Station Features

Accessible for everyone



- Up and down escalators at each station
- Elevators, with an extra elevator at Broadway-City Hall Station for more capacity at the Canada Line connection
- Clear and audible public address system
- Tactile tiles to support passengers with visual impairments
- Hands-free gate access for eligible customers and accessible ticket vending machines

Planning for the future



- Minimized footprint and visual impact of vent shafts
- Flat roofs and 'knock-out' panels to maximize potential for future development integration with the station
- Minimized size of emergency exit buildings and positioned to allow easy incorporation with future development
- Station plazas to support efficient passenger movements in all directions

Aesthetics



- Neighbourhood integration such as accent colours
- Promote and celebrate Indigenous and public art
- Trees and landscaping coordinated with the City of Vancouver

Design



- Consistent, familiar design and passenger flow across stations
- Enhanced Crime Prevention Through Environmental Design (CPTED) measures
- Incorporating stormwater retention

Amenities



- Single-occupancy washrooms in the Fare Paid Zone accessed with the assistance of a SkyTrain attendant
- Bike parking
- Indoor and outdoor seating

Great Northern Way–Emily Carr Station

Great Northern Way–Emily Carr Station will be located at the northeast corner of Thornton Street and Great Northern Way, adjacent to the Central Valley Greenway.



Artist's renderings of preliminary conceptual station design. Streetscape design to be finalized by City of Vancouver. Final building design is subject to the City of Vancouver's rezoning process.

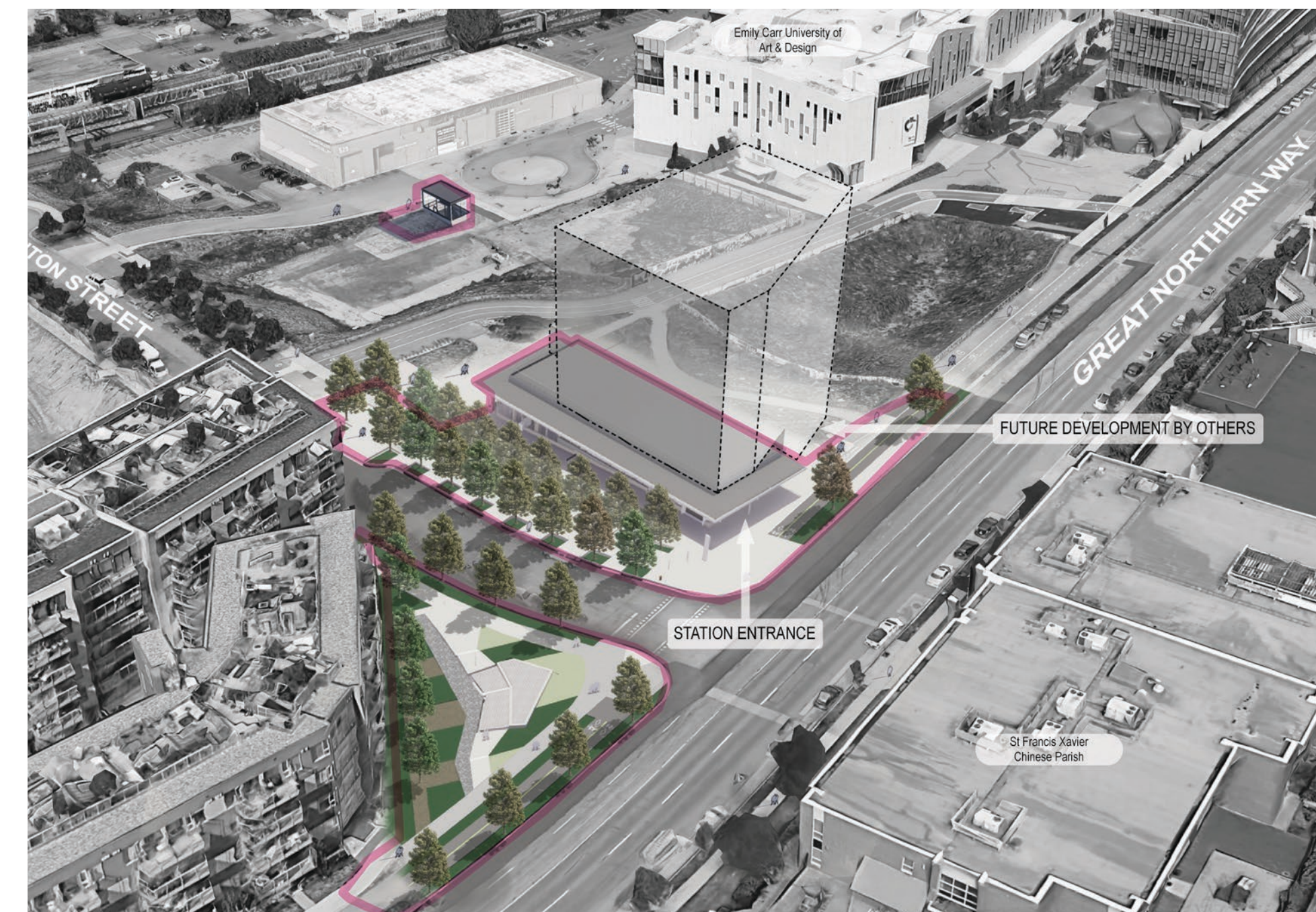

Connections



84



Central Valley
Greenway

Station Highlights



Two entryways



Indoor bike
parkade with
space for
34 bikes



Designed for
integration
with future
development

Mount Pleasant Station

Mount Pleasant Station will be located at the southwest corner of E. Broadway and Main Street.



Artist's renderings of preliminary conceptual station design.
Streetscape design to be finalized by City of Vancouver.



Connections



3, 8, 9, 19



7th Ave, 10th Ave,
Ontario St

Station Highlights



Weather-
protected
bike racks



Accent wall in
unique station
colour

Broadway–City Hall Station

Broadway–City Hall Station will use the existing entrance to the Canada Line at the southeast corner of W. Broadway and Cambie Street.



Connections



Canada Line



9, 15, 17



7th Ave, 10th Ave,
Yukon St

Station Highlights



Extra elevator
for added
capacity



Convenient,
underground
transfer to
Canada Line



Artist's renderings of preliminary conceptual station design.
Streetscape design to be finalized by City of Vancouver.



Oak-VGH Station

Oak-VGH Station will be located at the southwest corner of W. Broadway and Laurel Street, near Oak Street.



Artist's renderings of preliminary conceptual station design.
Streetscape design to be finalized by City of Vancouver.

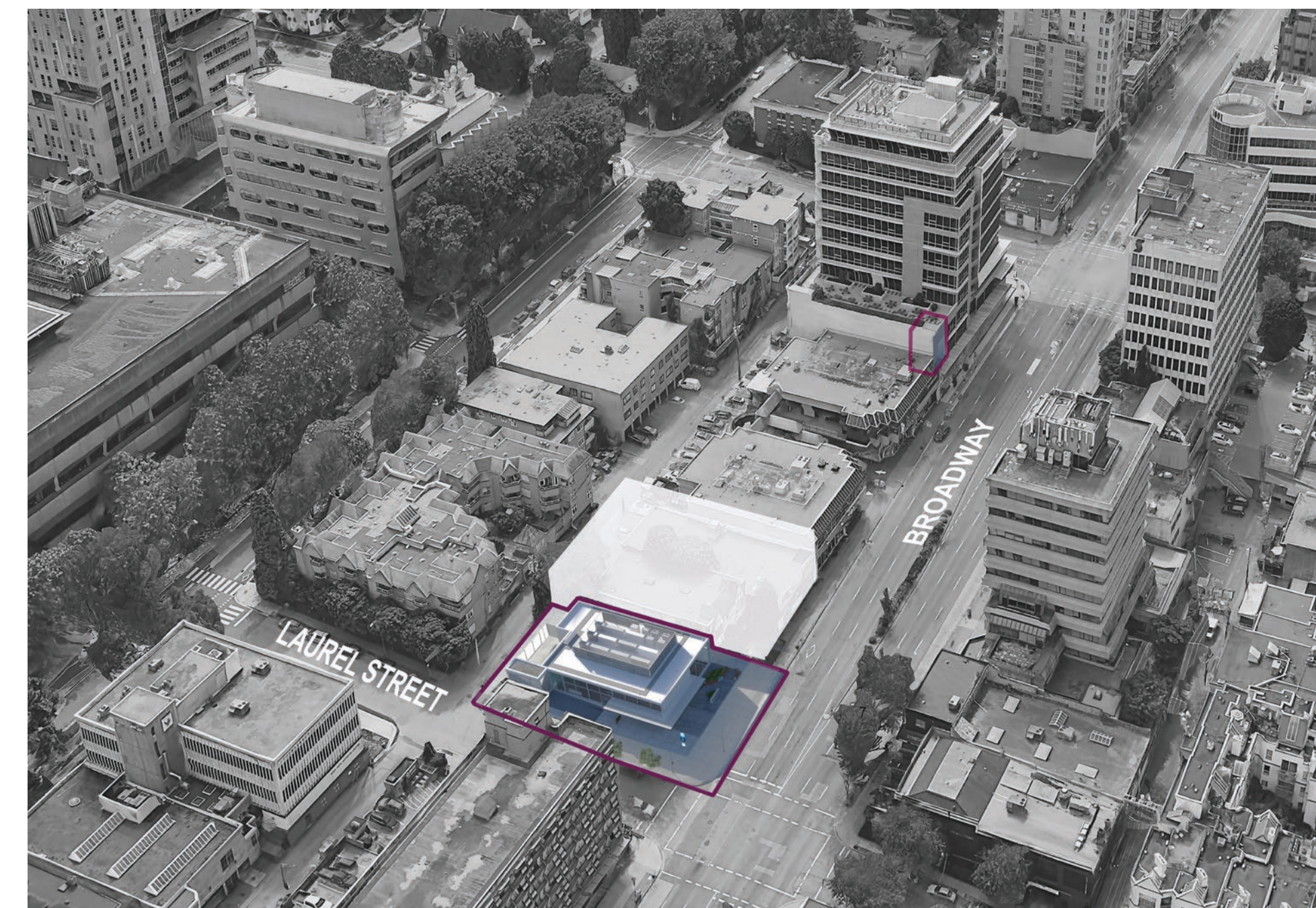

Connections



9, 17



7th Ave, 10th Ave,
Heather St

Station Highlights



Weather-
protected
bike racks



Accent wall in
unique station
colour

South Granville Station

South Granville Station will be located at the northeast corner of W. Broadway and Granville Street.



Artist's renderings of preliminary conceptual station design. Streetscape design to be finalized by City of Vancouver. Development above station subject to City of Vancouver's approved rezoning and development permit process.

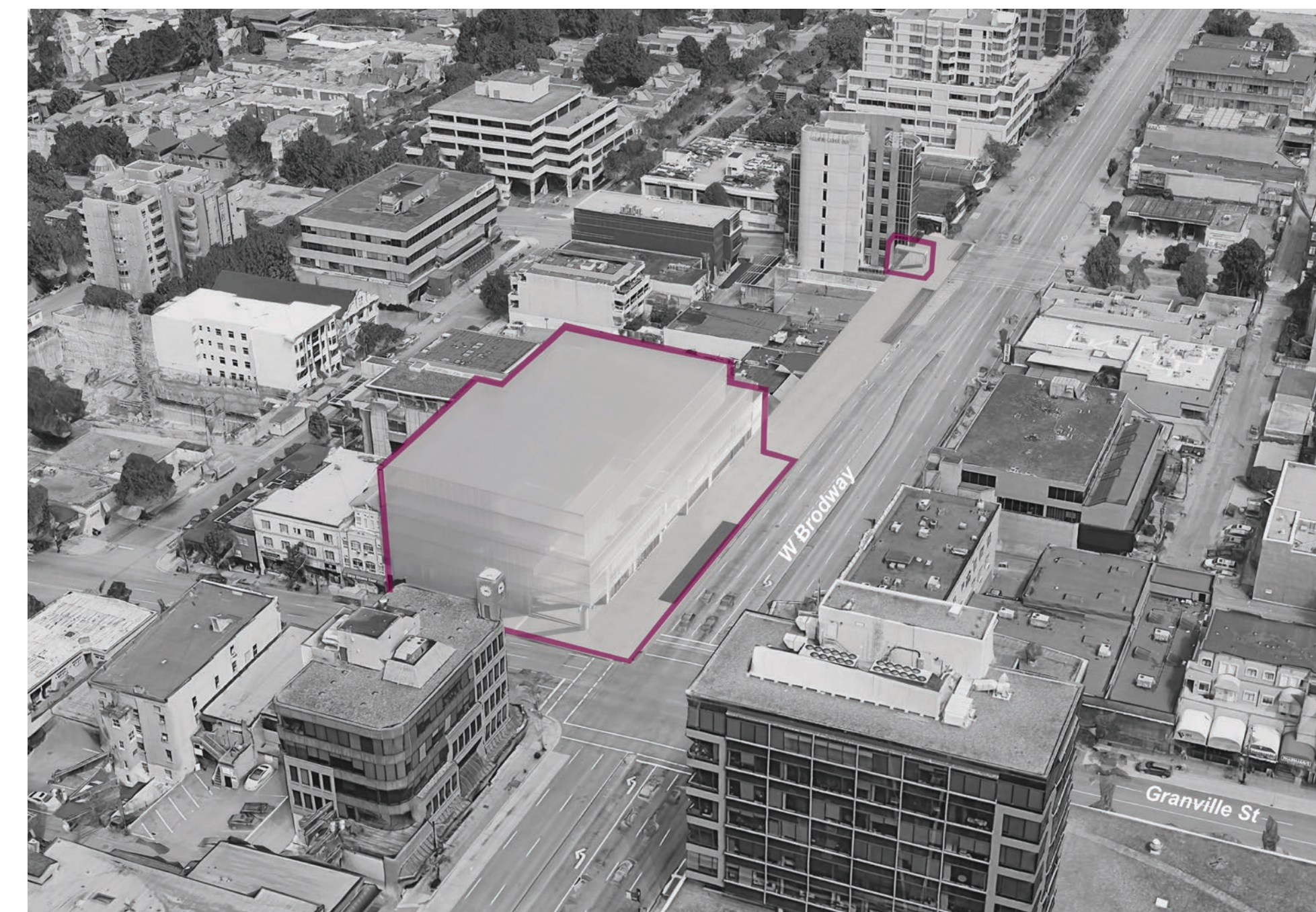

Connections

 9, 10, 16

 7th Ave,
10th Ave

Station Highlights

 Integrated
into new
development

Arbutus Station

Arbutus Station and bus loop will be located at the northeast corner of W. Broadway and Arbutus Street, adjacent to the Arbutus Greenway.



Artist's renderings of preliminary conceptual station design.
Streetscape design to be finalized by City of Vancouver.

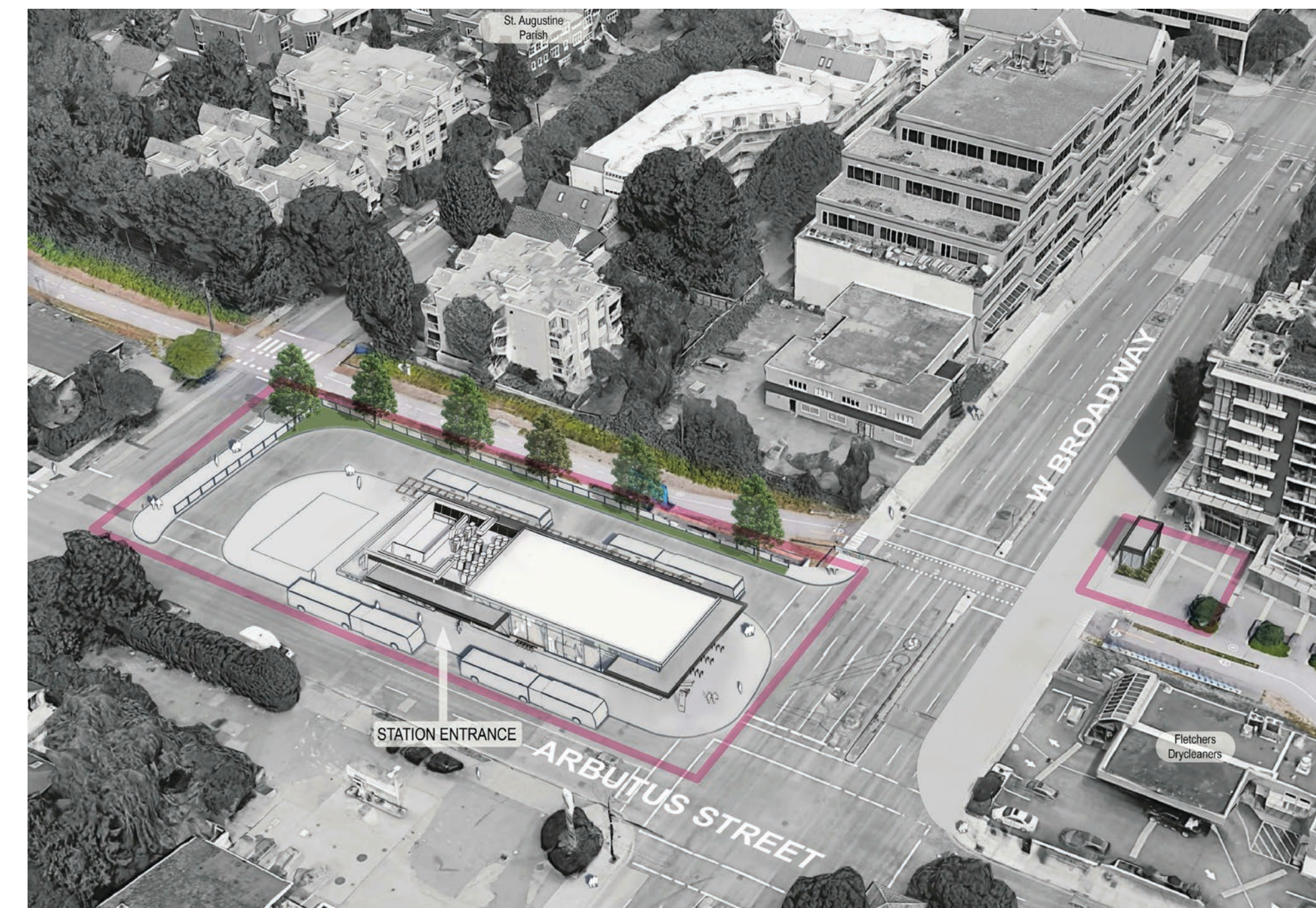

Connections



99, 9, 16



Arbutus Greenway,
7th Ave, 10th Ave

Station Highlights



Two entryways



Indoor bike
parkade with
space for
34 bikes



Accent wall in
unique station
colour